

Quarterly Roadmap Overview

May 2026

Q2 Roadmap

AI Wave - Guide every customer to value with an AI-first experience

Unlock your growth by putting admin power in the right hands

Prove the impact of your program with verified skill mastery and trusted data

Accelerate your team's productivity on a platform built for scale

Q1 Review

Build and launch high-impact content in a fraction of the time

Scale your multi-audience programs without increasing manual effort

Create an inclusive learner journey backed by high-fidelity insights

Q2 Roadmap

AI Wave - Guide every customer to value with an AI-first experience

Introducing the AI Wave, the next era of agentic learning, available now. Meet your learners at the exact moment of need with agentic AI that doesn't just deliver content, but triggers immediate enrollment, practice, and public discoverability across the AI-driven web.

Conversational AI Learning

STATUS: DELIVERED

Empower your learners with a modern, natural-language search experience that spans both the catalog and course content. Conversational responses let learners get to the right content faster and act on it directly — including agentic actions like one-step enrollment.

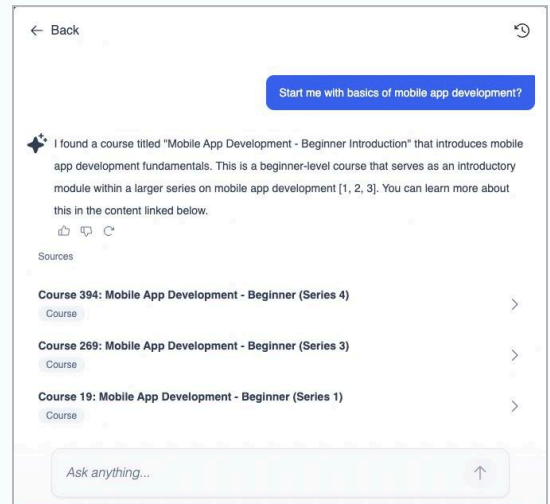

Enroll Me agent

STATUS: COMING SOON

An agentic capability that turns conversational answers into immediate action — letting a learner enroll in the right program in a single step from the conversational AI experience.

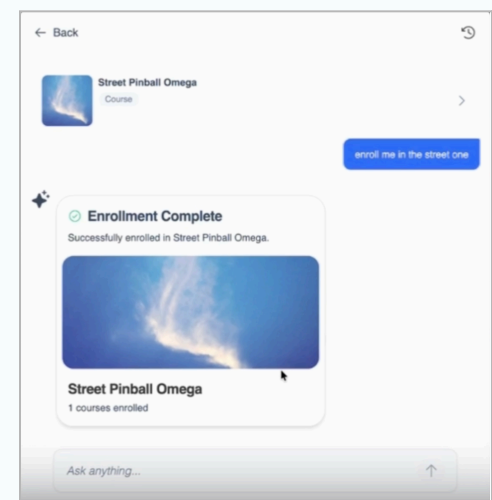

Omnichannel: Answer Engine Optimization (AEO)

STATUS: DELIVERED

Turn your academy into a discovery engine. Automated sitemaps and structured content optimization make your public learning content surface in AI answer engines, as well as traditional search engines like Google, putting your expertise in front of prospective learners at the exact moment they're considering your product and looking for answers.

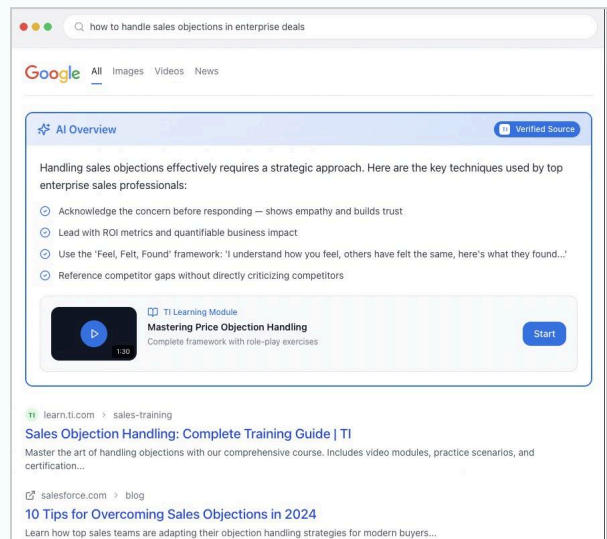

Q2 — Unlock your growth by putting admin power in the right hands

Remove central bottlenecks and empower your ecosystem by delegating oversight to frontline managers and automating complex user movements.

Manager Access to Assigned Learners

STATUS: PLANNED (Q2)

Put more granular learner oversight in the hands of team managers, allowing them to assign training and track progress for their specific groups.

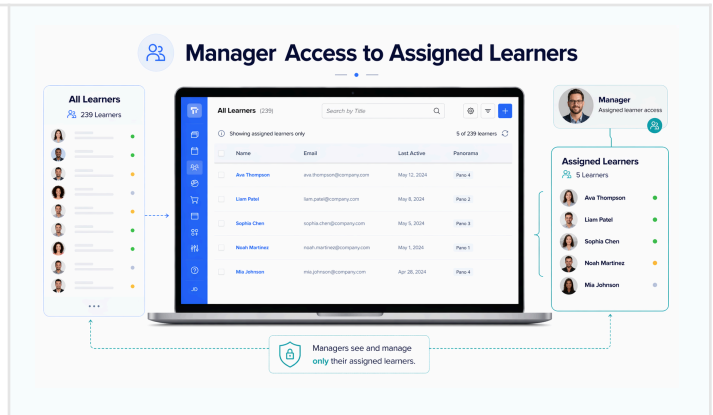

Panorama User Management Enhancement

STATUS: PLANNED (Q2)

High-precision user management tool that gives administrators explicit control over whether to preserve or reset learner progress when moving users between Panoramas and removing/adding licenses.

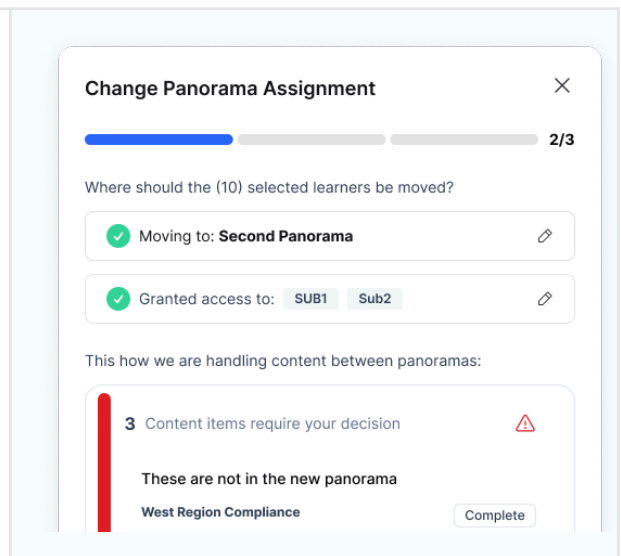

Q2 — Prove the impact of your program with verified skill mastery and trusted data

Bridge the gap between theory and practice by providing learners a safe space to rehearse, while giving administrators high-integrity reporting to prove ROI.

AI Personalized Coach & Role Play (Bongo integration)

STATUS: PLANNED (Q2)

Through role play simulations and AI-driven coaching, learners can practice and perfect newly acquired skills. By engaging in lifelike scenarios—such as support interactions or sales presentations—they receive immediate, data-driven feedback customized to your unique training goals and content.

DEMO VIDEO

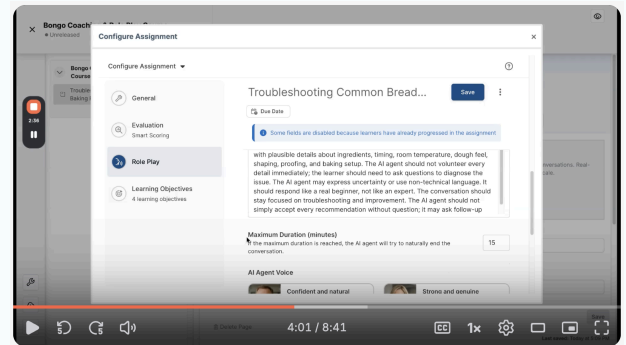

Reporting & Analytics Enhancements

STATUS: PLANNED (Q2 – GA)

Make every analytics data source and report a source of truth. Building on the status group improvements in BI Connector 2.0, we're closing the remaining gaps in record status (including deleted records) across standard and custom reports — so your administrators can interpret learner data with confidence and act on it without second-guessing.



Q2 — Accelerate your team’s productivity on a platform built for scale

Modernize your technical foundation and eliminate daily friction points, allowing your developers and administrators to build and scale faster with less manual effort.

SCORM Rustici Infrastructure Upgrade

STATUS: PLANNED (Q2)

Modernizing the SCORM engine with container optimization, database updates, and a dedicated UAT environment for improved reliability under load.



Product Usability & Accessibility Improvements

STATUS: PLANNED (Q2)

Eliminating daily “usability” pain points like inconsistent terminology and awkward save behaviors in course authoring.

Technical Documentation & Experience

STATUS: PLANNED (Q2)

A new unified Developer Hub that consolidates all REST and GraphQL references and implementation guides into one searchable destination.

DEMO VIDEO

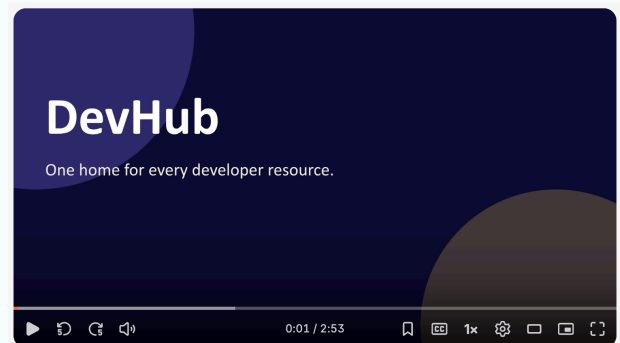

Q1 — Scale your multi-audience programs without increasing manual effort

Manage segmented learner bases and diverse commercial relationships and with ease, freeing your team to focus on strategy rather than administrative maintenance.

Panorama Learner Continuity

STATUS: DELIVERED

Learners with access to multiple licenses can now move between them and resume content progress more easily, making multi-audience programs feel cohesive.

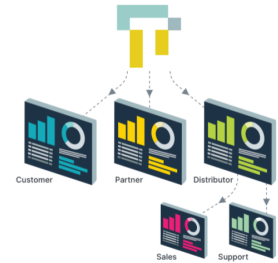

Refreshed Pages & Layouts Experience in Site Builder

STATUS: DELIVERED

A faster, clearer experience for managing site structure and design.

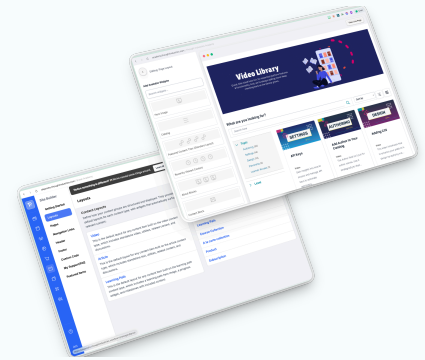

Expanded Controls in Scheduled Reports Manager

STATUS: DELIVERED

Greater administrative control over the timing and delivery of automated reporting.

Schedule Name	Report ID	Destination	Frequency	Last Delivery	Creator	Created	Actions
Learner Credit L...	Learner Credit L...	Email (I)	At 06:00 AM	1/10/2026 6:05:48 AM	lori.leiv...	12/29/2025 1:42:31 PM	Duplicate Delete
Testimonials Log	Testimonials Log	Email (I)	At 06:00 AM, on day 1 of the month	1/10/2026 6:00:23 AM	mshmer...	12/29/2025 11:54:11 AM	
Testimonials Log	Testimonials Log	Email (I)	At 06:00 AM, on day 1 of the month	1/10/2026 6:00:23 AM	mshmer...	12/29/2025 11:54:11 AM	
Copy Made in Re...	Free Registration ...	Email (I)	At 10:00 AM, on day 1 of the month, only in August		mshmer...	12/29/2025 9:35:21 AM	
August Free Reg...	Free Registration ...	Email (I)	At 10:00 AM, on day 1 of the month,		mshmer...	12/29/2025 9:33:31 AM	

Salesforce Integration Enhancements

STATUS: DELAYED

Ongoing investigation and planning to support deeper, more scalable two-way CRM workflows.



Q1 — Create an inclusive learner journey backed by high-fidelity insights

Strengthen your academy's reputation by providing a universally accessible experience and securing the high-precision data needed to drive your next strategic move.

Accessibility Standards Strengthening

STATUS: DELIVERED

Improved screen reader support and keyboard navigation to ensure the path to content is inclusive for every learner.

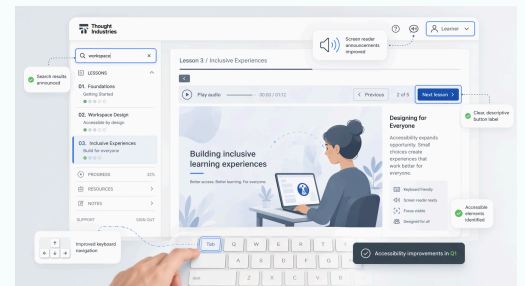

Panorama Content Actions Reporting Enhancements

STATUS: DELIVERED

More complete reporting on content actions for eligible Panorama admins to improve visibility into sublicense engagement.

Data Quality Improvements

STATUS: PARTIALLY DELIVERED

Meaningful improvements in reporting confidence and data access, including more complete Panorama content actions reporting for eligible Panorama admins, BI Connector 2.0 data quality and accuracy fixes, improvements to subscription purchase reporting, and ecommerce tracking support for third-party instrumentation.

What's next? There is continued work related to data governance to shift to proactive data quality identification, coverage of status group feature and backfill completion in BI Connector 2.0.